

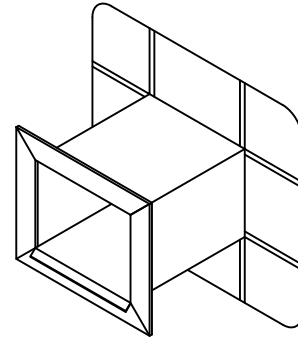

1-800-248-0280  
 831 Morley Drive  
 Saginaw, MI 48601

DETAIL E2060

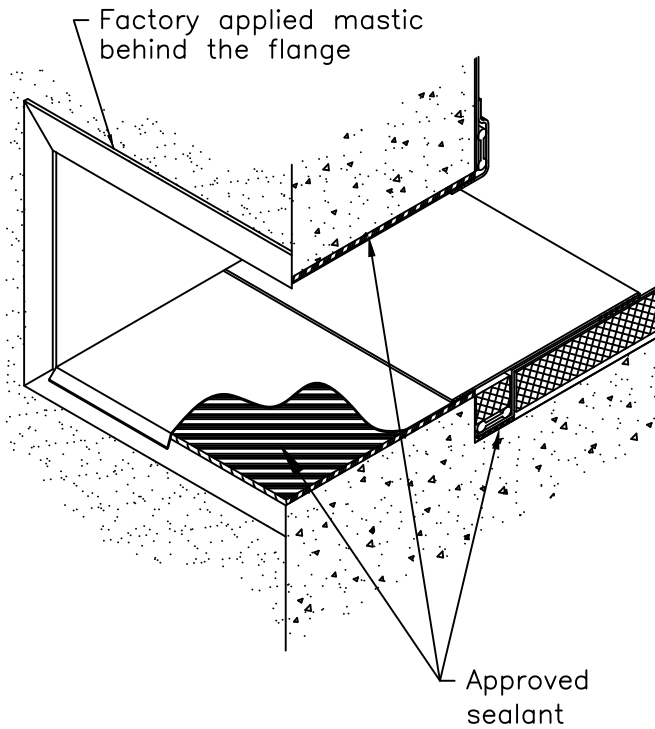

METAL FLANGE

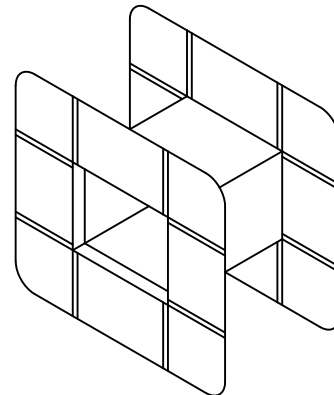

DOUBLE SKIRT

Note 1:  
 Metal Flanged Scuppers are back sealed using the factory supplied mastic behind the flange.

Note 2:  
 Approved sealant must be applied around the interior of the scupper before installing the scupper liner.

Note 3:  
 See Detail 2061 for the appropriate interior wall termination.

DATE: JANUARY 2013

DRAINAGE DETAILS

DRAWN BY: ENG. DEPT.

METAL FLANGE @ 2 SKIRT SCUPPER

SCALE: NONE

NEW CONSTRUCTION OR RE-ROOF